



# A Vintage French Chic Board

Use our step by step instructions to create this Stylish Vintage French Chic Board

Experience Level: **Intermediate**

You will need:

- CER017** Creative Expressions Sam Poole La Mode A6 Pre Cut Rubber Stamp
- CER019** Creative Expressions Sam Poole L'alteration A6 Pre Cut Rubber Stamp
- CSMCPVAN** Cosmic Shimmer Matt Chalk Paint Vanilla
- CSMCPSHALL** Cosmic Shimmer Matt Chalk Paint Shallow sea
- CSASPPPRU** Andy Skinner Pigment Paint Prussian Blue
- CSASAPPUMBER** Andy Skinner Pigment Paint Raw Umber
- CSASAPPGREY** Andy Skinner Pigment Paint Payne's Grey
- CSASAPPYEL** Andy Skinner Pigment Paint Yellow Iron Oxide
- CSARESPAST** Andy Skinner Resist Paste
- CSASGGLUE** Andy Skinner Quick Grab Glue
- ADHA4** Creative Expressions Double Sided Self-adhesive Sheets
- 41002** Creative Expressions Foundation Card Primrose



- 40980** Creative Expressions Foundation Card Coconut White
- KRAFTCARD** Creative Expressions Foundation Kraft Card
- CSSERUST** Cosmic Shimmer Special Effects Paint Kit Rust
- CESMOOTH** Creative Expressions Smoothies

**These handy tools will make your card creation process much simpler!**

Black Archival ink, Stamping block, Scissors, Lace, Buttons, Cream card, Sewing machine, Foam backed sticky pads

## Step by Step Instructions

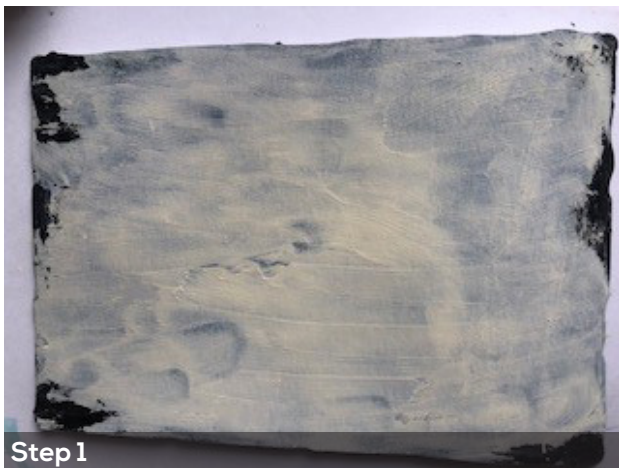

**Step 1**  
Cut your coconut card to size 4.25 inches by 6 inches then give it a base coat of Payne's Grey and Raw Umber 50/50. Once dry use Andy Skinner's Resist Paste where you wish the base to show through. Follow this with vanilla matt chalk paint and heat set, then take a soft cloth and rub back over the resist areas to remove the resist paste.

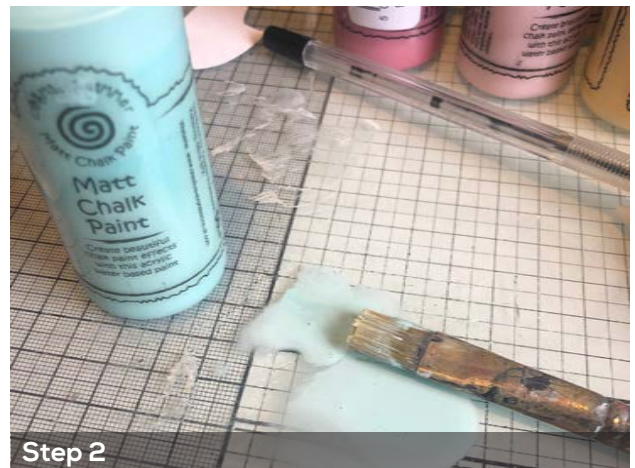

**Step 2**  
Ink up the le mode stamp with Black archival Ink, taking care to miss the edges you could mask them out if you wish, I didn't as I don't mind the odd hint of the boarder showing through. Once dry give a watery wash of Shallow sea matt paint and heat set reapply till happy making sure it is very watery. At this stage I added some stitching on the righthand side.



Step 3

Once you have stamped the main image stamp out again along with the top part of the L'alterations stamp on Primrose card then fussy cut the images out. Run a distress tool around the edges to create an uneven edge. Use your smoothie to apply a mix of Yellow Iron Oxide and Raw Umber together 70 yellow / 30 umber and apply to the edges of the base card and your cut out images follow with Prussian blue.

**Tip:** test out on scrap card so you don't overload it.

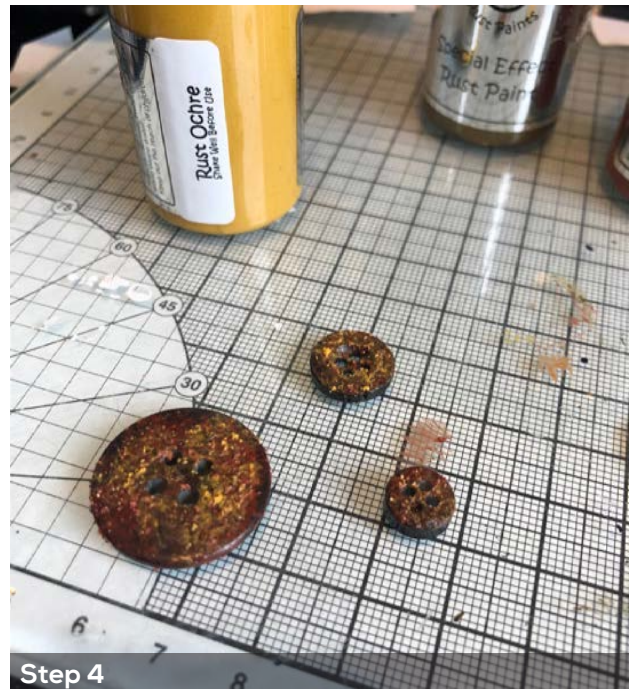

Step 4

I found 3 black buttons in my stash and thought I would give them a rusty finish. I applied rust special effects paint to them. This product is amazing as it has quite a textured finish to it. I dried each colour before applying the next and I used a stipple brush to apply.



Step 5

Apply the double sided self-adhesive sheet to your project and mat to the kraft card, using a distress tool and repeat the process that you used on the main project. Apply a strip of double sided self-adhesive sheet to the left hand side of your main image and stick down the lace. Follow this by attaching your buttons and the tittle piece from the L'alterations stamp.



Step 6

Finally attach your corsets with the double sided pads so they sit proud of the base image.